

**PWMN N
MWMN N**
—

Recommendations
Empfehlungen
Rekommendationer

Page: Seite:
Sida: **B12-B17**

50°

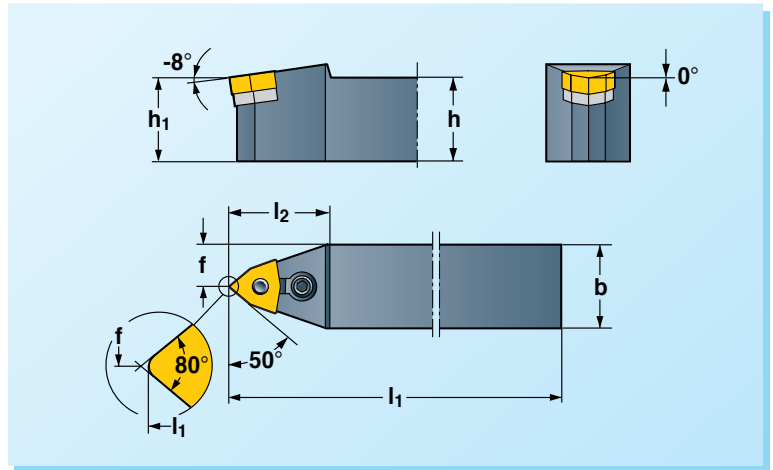
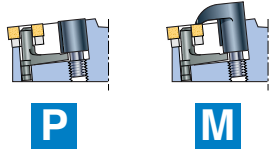

		h=h ₁	b	l ₁	l ₂	f								WNMA* WNMM WNMG	Page: Seite: Sida: B172-B178
P	PWMN N 2020-06 PWMN N 2525-06	20 25	20 25	125 150	27 27	10 12.5	LP61	UWN06	RS61K	D61	PS61	—	NY3	0604 . .	
	PWMN N 2525-08 PWMN N 3225-08 PWMN N 3232-08	25 32 32	25 25 32	150 170 170	36 36 36	12.5 12.5 16	LP62K	UWN08	RS62	D62	PS62	—	NY4	0804 . .	
M	MWMN N 2020-06 MWMN N 2525-06	20 25	20 25	125 150	27 27	10 12.5	LP61	UWN06	RS61K	D61	—	MS61	NY3	0604 . .	
	MWMN N 2525-08 MWMN N 3225-08 MWMN N 3232-08	25 32 32	25 25 32	150 170 170	36 36 36	12.5 12.5 16	LP62K	UWN08	RS62	D62	—	MS62	NY4	0804 . .	

**PCSN R/L
MCSN R/L
CCSN R/L**

Recommendations
Empfehlungen
Rekommendationer

Page: Seite:
Sida: **B12-B17**

45°

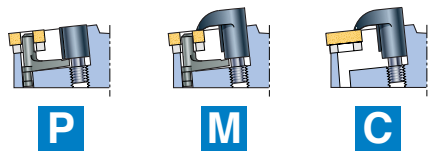

The drawing shows right-hand version. Left-hand version reversed.
Die Zeichnung zeigt Rechtsausführung. Linksausführung umgekehrt.
Ritningen visar högerutförande. Vänsterutförande speglvänt.

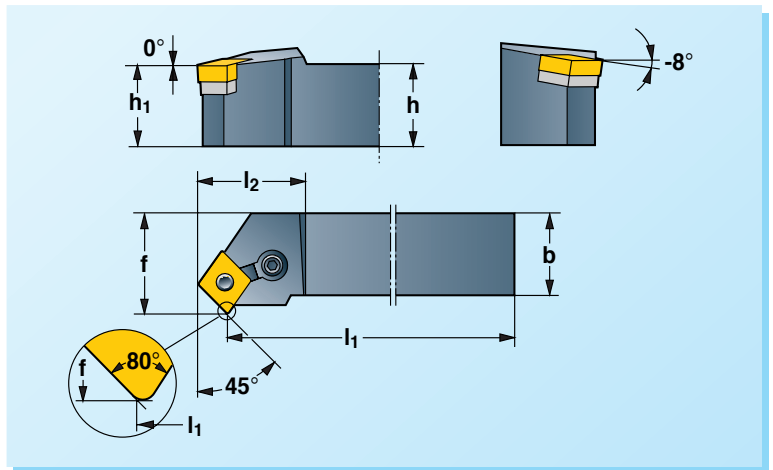

			h=h ₁	b	l ₁	l ₂	f							CNMA* CNMM CNMG	Page: Seite: Sida: B172-B178
P	PCSN R/L 2020-12 PCSN R/L 2525-12 PCSN R/L 3225-12		20 25 32	20 25 25	125 150 170	35 35 35	25 32 32	LP62K	UCN12	RS62	D62	PS62K PS62 PS62	—	NY4	1204 . .
M	MCSN R/L 2020-12 MCSN R/L 2525-12 MCSN R/L 3225-12		20 25 32	20 25 25	125 150 170	35 35 35	25 32 32	LP62K	UCN12	RS62	D62	—	MS62K MS62 MS62	NY4	1204 . .
C	CCSN R/L		See page — Siehe Seite — Se sida			B16-B17									

¹⁾ Standard delivery for inserts with 4.76 mm thickness.
²⁾ Separate delivery for inserts with 3.18 mm thickness.

¹⁾ Standardlieferung für Schneiden mit 4,76 mm Dicke.
²⁾ Lieferung auf besondere Bestellung für Schneiden mit 3,18 mm Dicke.

¹⁾ Standardleverans för skär med 4,76 mm tjocklek.
²⁾ Separat leverans för skär med 3,18 mm tjocklek.

*
 Selection of cutting geometry page:
Wahl der Schneidgeometrie, Seite: **B27-B39**
Val av skärgeometri, sid:

Ordering example:
Bestellbeispiel: **PTTNR 2525-22**
Beställningsexempel:

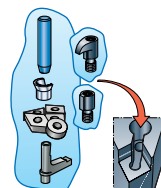

Spare parts shown in the coloured columns are supplied assembled in each tool.
Die in den farbigen Spalten aufgeführten Ersatzteile sind in den Werkzeugen montiert.
Reservdelar i de färgade kolumnerna ingår monterade i varje verktyg.

**PTDN R/L
MTDN R/L
CTDN R/L**

Recommendations
Empfehlungen
Rekommendationer

Page: Seite:
Sida: **B12-B17**

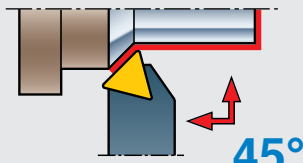

45°

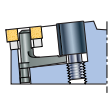

P

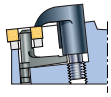

M

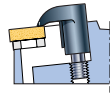

C

The drawing shows right-hand version. Left-hand version reversed.
Die Zeichnung zeigt Rechtsausführung. Linksausführung umgekehrt.
Ritningen visar högerutförande. Vänsterutförande spegelvänt.

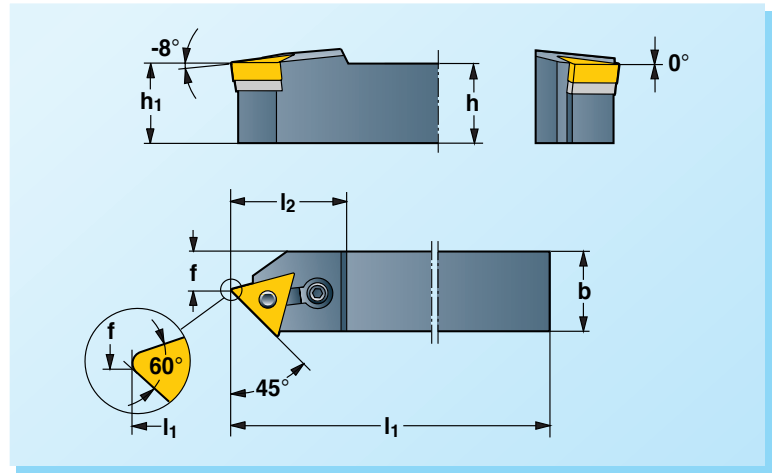

B



$h=h_1$

b

l_1

l_2

f



TNMA *
TNMM
TNMG

Page:
Seite:
Sida:

B172-B178

		$h=h_1$	b	l_1	l_2	f								
P	PTDN R/L 2525-22 PTDN R/L 3225-22	25 32	25 25	150 170	36 36	13 13	LP62K	UTN22	RS62	D62	PS62	-	NY4	TNMA 2204 ..
M	MTDN R/L 2525-22 MTDN R/L 3225-22	25 32	25 25	150 170	36 36	13 13	LP62K	UTN22	RS62	D62	-	MS62	NY4	TNMM 2204 ..
C	CTDN R/L	See page - Siehe Seite - Se sida B16-B17												

**PSSN R/L
MSSN R/L
CSSN R/L**

Recommendations
Empfehlungen
Rekommendationer

Page: Seite:
Sida: **B12-B17**

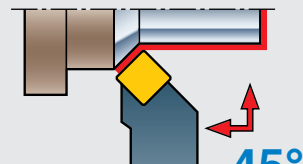

45°

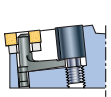

P

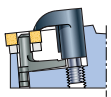

M

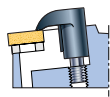

C

The drawing shows right-hand version. Left-hand version reversed.
Die Zeichnung zeigt Rechtsausführung. Linksausführung umgekehrt.
Ritningen visar högerutförande. Vänsterutförande spegelvänt.

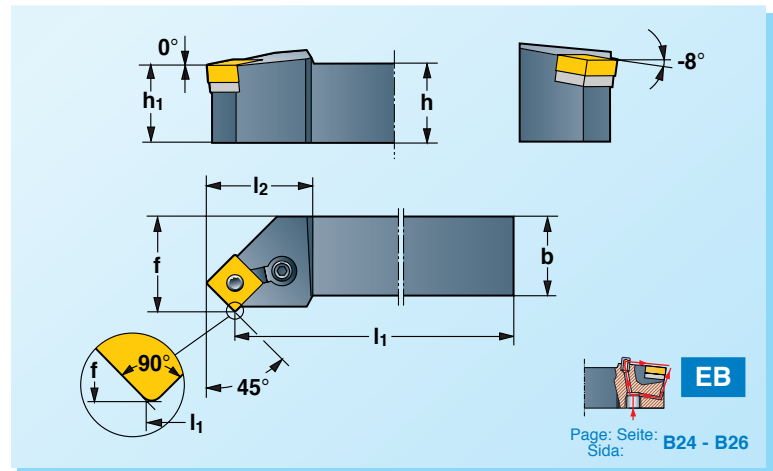

Page: Seite:
Sida: **B24 - B26**



$h=h_1$

b

l_1

l_2

f



SNMA *
SNMM
SNMG

Page:
Seite:
Sida:

B172-B178

		$h=h_1$	b	l_1	l_2	f								
P	PSSN R/L 1616-09 PSSN R/L 2020-09	16 20	16 20	100 125	24 24	20 25	LP61	USN09	RS61	D61	PS61	-	NY3	SNMA 0903 ..
	PSSN R/L 2020-12 PSSN R/L 2525-12 PSSN R/L 3225-12	20 25 32	20 25 25	125 150 170	33 33 33	25 32 32	LP62K	USN12	RS62	D62	PS62	-	NY4	SNMM 1204 ..
	PSSN R/L 2525-15 PSSN R/L 3225-15 PSSN R/L 3232-15	25 32 32	25 25 32	150 170 170	39 39 39	32 32 40	LP64	USN15	RS64	D64	PS62	-	NY4	SNMG 1506 ..
	PSSN R/L 3232-19 PSSN R/L 4040S19	32 40	32 40	170 250	43 43	40 50	LP65	USN19	RS65	D65	PS62	-	NY4	1906 ..
M	MSSN R/L 1616-09 MSSN R/L 2020-09	16 20	16 20	100 125	24 24	20 25	LP61	USN09	RS61	D61	-	MS61	NY3	0903 ..
	MSSN R/L 2020-12 MSSN R/L 2525-12 MSSN R/L 3225-12	20 25 32	20 25 25	125 150 170	33 33 33	25 32 32	LP62K	USN12	RS62	D62	-	MS62	NY4	1204 ..
	MSSN R/L 2525-15 MSSN R/L 3225-15 MSSN R/L 3232-15	25 32 32	25 25 32	150 170 170	39 39 39	32 32 40	LP64	USN15	RS64	D64	-	MS63	NY4	1506 ..
	MSSN R/L 3232-19 MSSN R/L 4040S19	32 40	32 40	170 250	43 43	40 50	LP65	USN19	RS65	D65	-	MS63	NY4	1906 ..
C	CSSN R/L	See page - Siehe Seite - Se sida B16-B17												

**PSDN N
MSDN N
CSDN N**

Recommendations
Empfehlungen
Rekommendationer

Page: Seite:
Sida: **B12-B17**

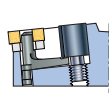
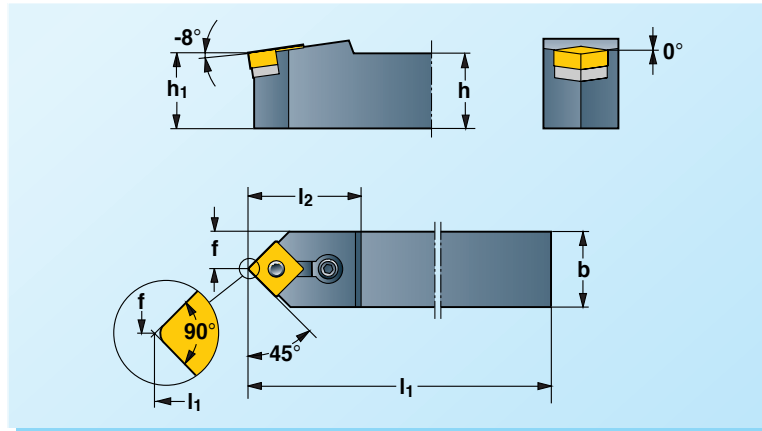

P

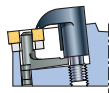

M

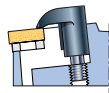

C

		$h=h_1$	b	l_1	l_2	f								CNMA	CNMM	CNMG	Page: Seite: Sida: B172-B178	
P	PSDN N 1616-09	16	16	100	25	8	LP61	USN09	RS61	D61	PS61	–	NY3	0903 . .				
	PSDN N 2020-12	20	20	125	34	10	LP62K	USN12	RS62	D62	PS62	–	NY4	1204 . .				
	PSDN N 2525-12	25	25	150	34	12.5												
	PSDN N 3225-12	32	25	170	34	12.5												
	PSDN N 3225-19	32	25	170	44	12.5	LP65	USN19	RS65	D65	PS62	–	NY4	1906 . .				
	PSDN N 3232-19	32	32	170	44	16												
M	MSDN N 1616-09	16	16	100	25	8	LP61	USN09	RS61	D61	–	MS61	NY3	0903 . .				
	MSDN N 2020-12	20	20	125	34	10	LP62K	USN12	RS62	D62	–	MS62	NY4	1204 . .				
	MSDN N 2525-12	25	25	150	34	12.5												
	MSDN N 3225-12	32	25	170	34	12.5												
	MSDN N 3225-19	32	25	170	44	12.5	LP65	USN19	RS65	D65	–	MS63	NY4	1906 . .				
	MSDN N 3232-19	32	32	170	44	16												
C	CSDN N	See page – Siehe Seite – Se sida B16-B17																

*



Selection of cutting geometry page:
Wahl der Schneidgeometrie, Seite:
Val av skärgeometri, sid:

B27-B39

Ordering example:

Bestellbeispiel: **MSDNN 2525-12**

Beställningsexempel:

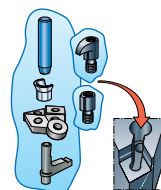

Spare parts shown in the coloured columns are supplied assembled in each tool.

Die in den farbigen Spalten aufgeführten Ersatzteile sind in den Werkzeugen montiert.

Reservdelar i de färgade kolumnerna ingår monterade i varje verktyg.

**PRSN R/L
MRSN R/L
CRSN R/L**

Recommendations
Empfehlungen
Rekommendationer

Page: Seite: **B12-B17**
Sida:

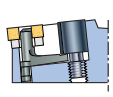
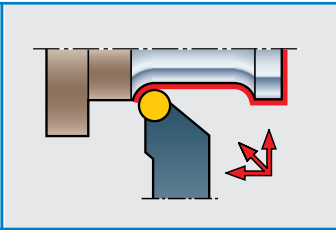

P

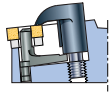

M

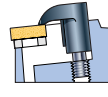





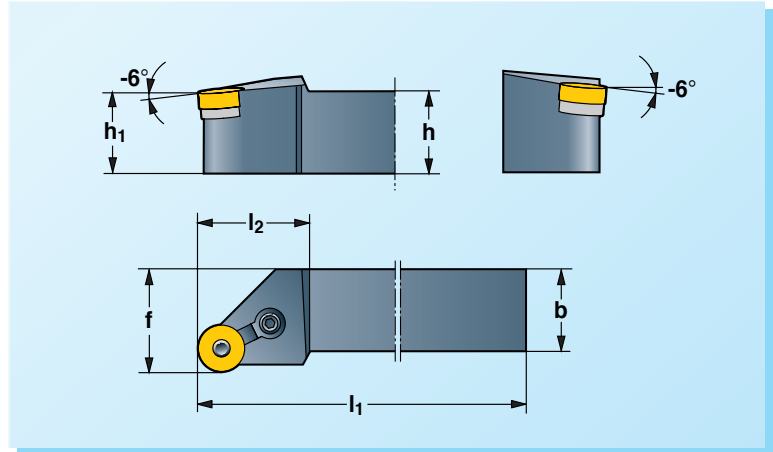





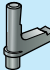

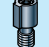

C

The drawing shows right-hand version. Left-hand version reversed.
Die Zeichnung zeigt Rechtsausführung. Linksausführung umgekehrt.
Ritningen visar högerutförande. Vänsterutförande spegelvänt.



B

			$h=h_1$	b	l_1	l_2	f								RNMA 	RNMG 	Page: Seite: Sida:	
P	PRSN R/L 2020-09		20	20	125	24	25	LP61	URN09	RS61	D61	PS61	–	NY3			090300	B172-B178
	PRSN R/L 2020-12		20	20	125	29	25	LP62K	URN12	RS62	D62	PS62	–	NY4			120400	
	PRSN R/L 2525-12		25	25	150	29	32	LP62K	URN12	RS62	D62	PS62	–	NY4			150600	
	PRSN R/L 3225-15		32	25	170	36	32	LP64	URN15	RS64	D64	PS62	–	NY4			150600	
	PRSN R/L 3232-19		32	32	170	38	40	LP65	URN19	RS65	D65	PS62	–	NY4			190600	
M	MRSN R/L 2020-09		20	20	125	24	25	LP61	URN09	RS61	D61	–	MS61	NY3			090300	B172-B178
	MRSN R/L 2020-12		20	20	125	29	25	LP62K	URN12	RS62	D62	–	MS62	NY4			120400	
	MRSN R/L 2525-12		25	25	150	29	32	LP62K	URN12	RS62	D62	–	MS62	NY4			120400	
	MRSN R/L 3225-15		32	25	170	36	32	LP64	URN15	RS64	D64	–	MS63	NY4			150600	
	MRSN R/L 3232-19		32	32	170	38	40	LP65	URN19	RS65	D65	–	MS63	NY4			190600	
C	CRSN R/L		See page – Siehe Seite – Se sida		B16-B17													

- *  Selection of cutting geometry page:
-  Wahl der Schneidgeometrie, Seite:
-  Val av skärgeometri, sid:

B27-B39

Ordering example:

Bestellbeispiel: **PRSNL 2020-09**

Beställningsexempel:

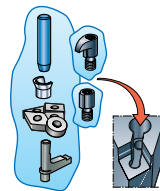

Spare parts shown in the coloured columns are supplied assembled in each tool.

Die in den farbigen Spalten aufgeführten Ersatzteile sind in den Werkzeugen montiert.

Reservdelar i de färgade kolumnerna ingår monterade i varje verktyg.

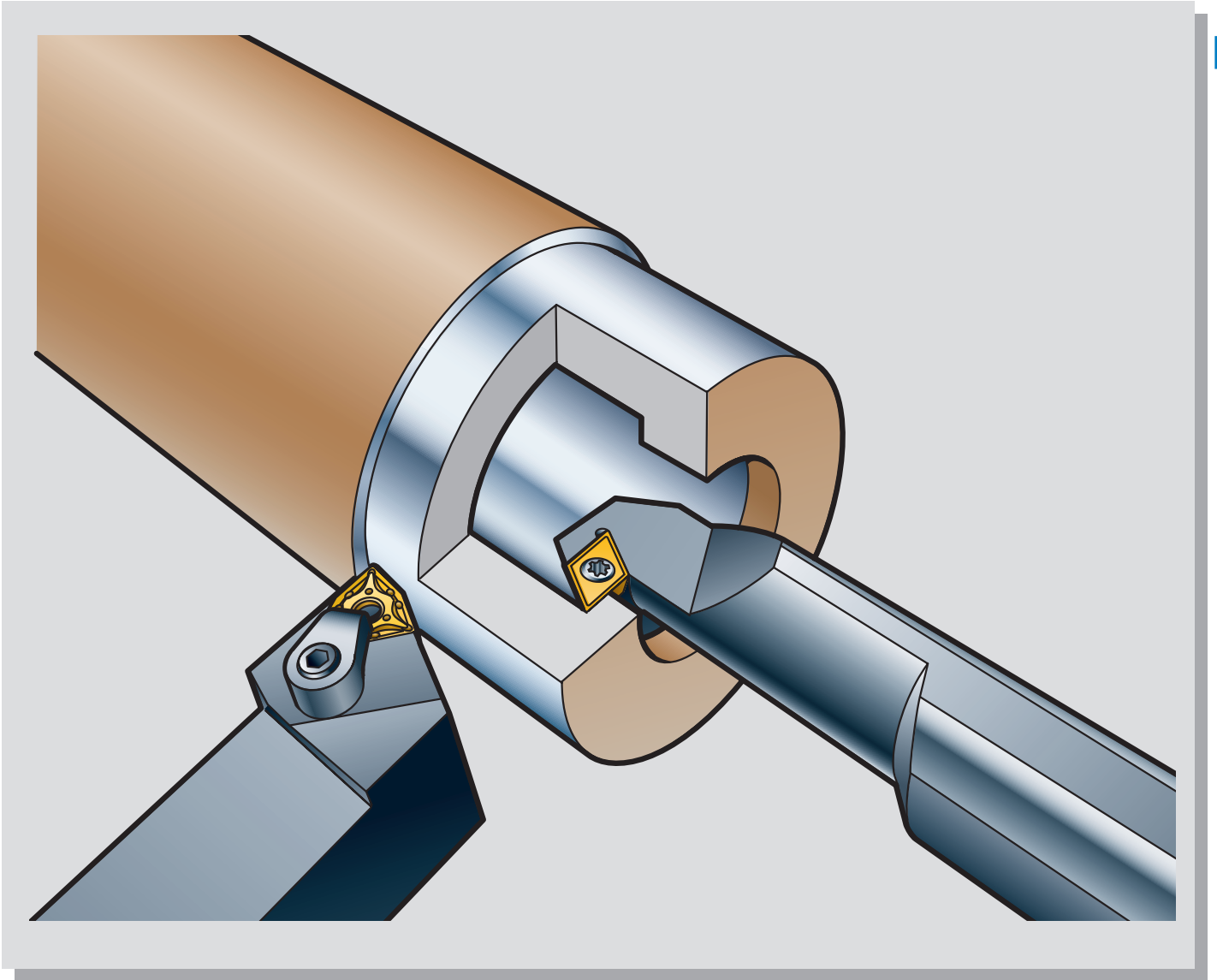

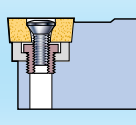



B

										Page Seite Sida								
		0606	0808	1010	1212	1414	1616	2020	2525			3225						
	SDHC R/L			07	07			11	11	11			B67					
	SVHB R/L								16	16	16		B67					
	SVZB R/L								16	16			B68					
	SCLC R/L	06	06	06				09		09			12	12	12	B68		
	SWLC R/L		04	04				06		06	06			08		B69		
	SDJC R/L		07	07				11		11	11	11		15	15	B69		
	SVJC R/L							11		11	11	11		16	16	16	B70	
	SVJB R/L																	
	SCAC R/L		06	06				09	09							B70		
	SCFC R/L		06	06				09		09						B71		
	SCGC R/L		06	06				09		09						B71		
	STGC R/L		09	09				11		11	16	16	16	16		B72		
	STFC R/L									16	16	16	16			B72		

											Page Seite Sida	 Page: Seite: Sida: B24 - B26		
		0606	0808	1010	1212	1414	1616	2020	2525	3225				
 90°	STFC R/L M							11	11	16	16	B73		
 91°	SDAC R/L		07	07	07	11						B73		
 75°	SCBC R/L		06	06			09					B74		
 75°	SCRC R/L				09		09					B74		
 75°	SSBC R/L							12	12	12	12	B75		
 75°	SSKC R/L						09	12	12	12	12	B75		
 72,5°	SVVC N SVVB N				11		11	11	11	16	16	16	B76	
 62,5°	SDNC N		07	07	07	11	11	11	11	15	15	B76		
 60°	SCEC R/L			06			09					B77		
 60°	STTC R/L								16	16	16	B77		
 50°	SCMC N		06	06		09		09				B78		
 45°	SCSC R/L							12	12	12	12	B78		
 45°	SSSC R/L						09	12	12	12	12	B79		

B

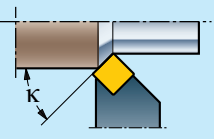

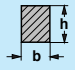
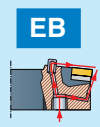
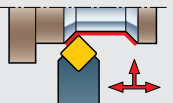
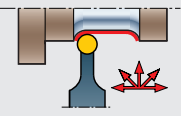
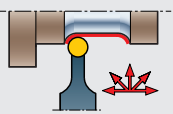
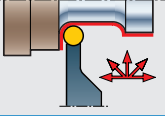
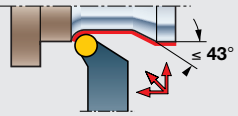
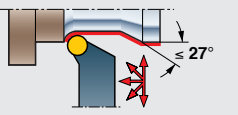
												Page Seite Sida	 Page: Seite: Sida: B24 - B26		
		0606	0808	1010	1212	1414	1616	2020	2525	3225	4032				
 45°	SSDC N				09		09		12	12	12			B79	
	SRDC N				06		06 08 10	06 08 10	06 08 10			12		B80	
	SRDC N M Roughing Schruppen Grovsvärning								12 16	12 16	16 20	16 20		B80	
	SRDC R/LM							06 08	06 08	06 08				B81	
	SRSC R/L				06		06 08 10	06 08 10	06 08 10			12		B81	
	SRSC R/L M Roughing Schruppen Grovsvärning								12	12	16 20	16 20		B82	

B

SDHC R/L

Recommendations
Empfehlungen
Rekommendationer

Page: Seite: Sida:

B12-B14, B18

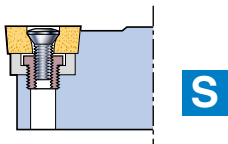

The drawing shows right-hand version. Left-hand version reversed.
Die Zeichnung zeigt Rechtsausführung. Linksausführung umgekehrt.
Ritningen visar högerutförande. Vänsterutförande spegelvänt.

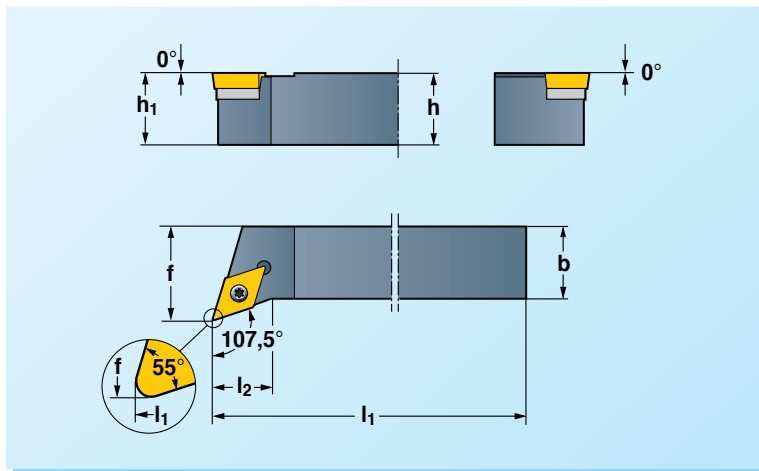

	$h=h_1$	b	l_1	l_2	f						DCMW * DCMT DCXT	Page: Seite: Sida: B179-B184
SDHCR/L 1010E07 SDHCR/L 1212F07	10 12	10 12	70 80	5,5 12,0	12 16	FTX072507	NY7X	-	-	-	0702 . .	
SDHCR/L 1616H11 SDHCR/L 2020K11 SDHCR/L 2525M11	16 20 25	16 20 25	100 125 150	10,5 14,0 20,0	20 25 32	FTX153514	NY15X	UDC11	RSM508	NY3.5	11T3 . .	

SVHB R/L

Recommendations
Empfehlungen
Rekommendationer

Page: Seite: Sida:

B12-B14, B18

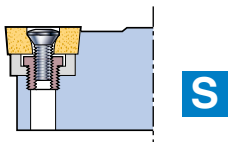

The drawing shows right-hand version. Left-hand version reversed.
Die Zeichnung zeigt Rechtsausführung. Linksausführung umgekehrt.
Ritningen visar högerutförande. Vänsterutförande spegelvänt.

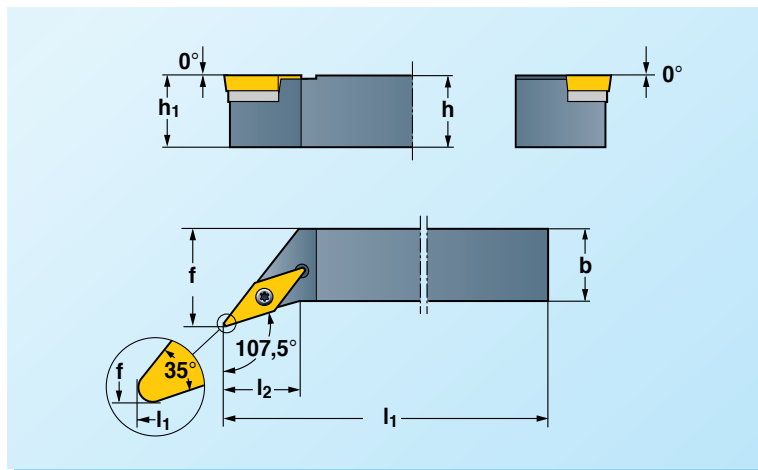

	$h=h_1$	b	l_1	l_2	f						VBMW * VBMT VCXT	Page: Seite: Sida: B179-B184
SVHBR/L 2020K16 SVHBR/L 2525M16 SVHBR/L 3225P16	20 25 32	20 25 25	125 150 170	13,5 20 20	25 32 32	FTX153514	NY15X	UVB16	RSM508	NY3.5	1604 . .	

* Selection of cutting geometry page:
Wahl der Schneidengeometrie, Seite: **B27-B39**
Val av skärgeometri, sid:

Ordering example:
Bestellbeispiel: **SVHBR 2020K16**
Beställningsexempel:

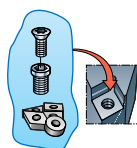

Spare parts shown in the coloured columns are supplied assembled in each tool.

Die in den farbigen Spalten aufgeführten Ersatzteile sind in den Werkzeugen montiert.

Reservdelar i de färgade kolumnerna ingår monterade i varje verktyg.

SVZB R/L

Recommendations
Empfehlungen
Rekommendationer

Page: Seite: Sida:

B12-B14, B18

$\leq 40^\circ$

100°

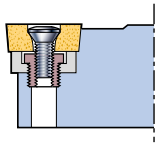

S

The drawing shows right-hand version. Left-hand version reversed.
Die Zeichnung zeigt Rechtsausführung. Linksausführung umgekehrt.
Ritningen visar högerutförande. Vänsterutförande spegelvänt.

0°

h_1

h

b

f

100°

35°

l_1

l_2

B

	$h=h_1$	b	l_1	l_2	f						VBMW VCMW VBMT VCMT VCXT	*	Page: Seite: Sida:
 							torx						B179-B184
SVZBR/L 2020K16M	20	20	125	30	25	FTX153514	NY15X	UVB16	RSM508	NY3.5			1604 . .
SVZBR/L 2525M16M	25	25	150	30	32								

SCLC R/L

Recommendations
Empfehlungen
Rekommendationer

Page: Seite: Sida:

B12-B14, B18

95°

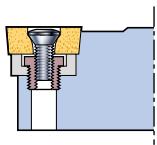

S

The drawing shows right-hand version. Left-hand version reversed.
Die Zeichnung zeigt Rechtsausführung. Linksausführung umgekehrt.
Ritningen visar högerutförande. Vänsterutförande spegelvänt.

0°

h_1

h

b

f

95°

80°

95°

l_1

l_2

Page: Seite: Sida: **B24 - B26**

	$h=h_1$	b	l_1	l_2	f						CCMW CCMT CCXT	*	Page: Seite: Sida:
 							torx						B179-B184
SCLCR/L 0606C06	6	6	50	10	8								
SCLCR/L 0808D06	8	8	60	10	10	FTX072507	NY7X	-	-	-			0602 . .
SCLCR/L 1010E06	10	10	70	10	12								
SCLCR/L 1212F09	12	12	80	16	16	FTX154010	NY15X	-	-	-			09T3 . .
SCLCR/L 1616H09	16	16	100	16	20	FTX153512	NY15X	UCC09	RSM5T	NY2.5			
SCLCR/L 2020K12	20	20	125	21	25								
SCLCR/L 2525M12	25	25	150	21	32	FTX154512	NY15X	UCC12	RSM6	NY3			1204 . .
SCLCR/L 3225P12	32	25	170	21	32								

SWLCR/L

Recommendations
Empfehlungen
Rekommendationer

Page: Seite: Sida:

B12-B14, B18

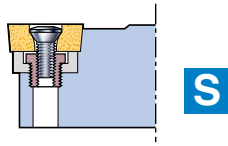

The drawing shows right-hand version. Left-hand version reversed.
Die Zeichnung zeigt Rechtsausführung. Linksausführung umgekehrt.
Ritningen visar högerutförande. Vänsterutförande spegelvänt.

Page: Seite: Sida: **B24 - B26**

EB

	h=h ₁	b	l ₁	l ₂	f						WCMW * WCMT	Page: Seite: Sida: B179-B184
							torx					
SWLCR/L 0808X04	8	8	120	10	10	FTX072507	NY7X	-	-	-	0402 . .	
SWLCR/L 1010X04	10	10	120	10	12							
SWLCR/L 1212X06	12	12	120	15	16	FTX154010	NY15X	-	-	-	06T3 . .	
SWLCR/L 1616H06	16	16	100	15	20							
SWLCR/L 2020K06	20	20	125	15	25							
SWLCR/L 2525M08	25	25	150	20	32	FTX154512	NY15X	-	-	-	0804 . .	

SDJCR/L

Recommendations
Empfehlungen
Rekommendationer

Page: Seite: Sida:

B12-B14, B18

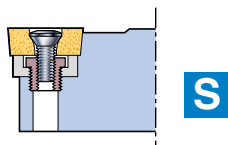

The drawing shows right-hand version. Left-hand version reversed.
Die Zeichnung zeigt Rechtsausführung. Linksausführung umgekehrt.
Ritningen visar högerutförande. Vänsterutförande spegelvänt.

Page: Seite: Sida: **B24 - B26**

EB

	h=h ₁	b	l ₁	l ₂	f						DCMW * DCMT DCXT	Page: Seite: Sida: B179-B184
							torx					
SDJCR/L 0808D07	8	8	60	15	10	FTX072507	NY7X	-	-	-	0702 . .	
SDJCR/L 1010E07	10	10	70	15	12							
SDJCR/L 1212F11	12	12	80	22	16	FTX154010	NY15X	-	-	-		
SDJCR/L 1616H11	16	16	100	22	20						11T3 . .	
SDJCR/L 2020K11	20	20	125	22	25	FTX153512	NY15X	UDC11	RSM5T	NY2.5		
SDJCR/L 2525M11	25	25	150	22	32							
SDJCR/L 2525M15	25	25	150	26	32	FTX154512	NY15X	UDC15	RSM6	NY3	1504 . .	
SDJCR/L 3225P15	32	25	170	26	32							

* Selection of cutting geometry page:
Wahl der Schneidgeometrie, Seite: **B27-B39**
Val av skärgeometri, sid:

Ordering example:
Bestellbeispiel: **SDJCR 2525M11**
Beställningsexempel:

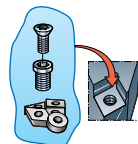

Spare parts shown in the coloured columns are supplied assembled in each tool.

Die in den farbigen Spalten aufgeführten Ersatzteile sind in den Werkzeugen montiert.

Reservdelar i de färgade kolumnerna ingår monterade i varje verktyg.

SVJB R/L
SVJC R/L

Recommendations
Empfehlungen
Rekommendationer
Page: Seite: Sida:
B12-B14, B18

93°

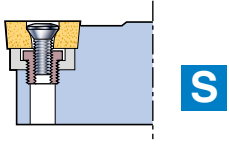

The drawing shows right-hand version. Left-hand version reversed.
Die Zeichnung zeigt Rechtsausführung. Linksausführung umgekehrt.
Ritningen visar högerutförande. Vänsterutförande spegelvänt.

EB

Page: Seite: **B24 - B26**
Sida:

B

	h=h ₁	b	l ₁	l ₂	f						VBMW VCMW VBMT VCMT VCXT	Page: Seite: Sida: B179-B184
SVJCR/L 1212M11 SVJCR/L 1616M11 SVJCR/L 2020K11 SVJCR/L 2525M11	12 16 20 25	12 16 20 25	150 150 125 150	30 30 30 30	16 20 25 32	FTX072507	NY7X	-	-	-	VCM_ 1103 . .	
SVJBR/L 2020K16 SVJBR/L 2525M16 SVJBR/L 3225P16	20 25 32	20 25 25	125 150 170	40 40 40	25 32 32	FTX153512	NY15X	UVB16	RSM5T	NY2.5	VBM_VCM_ 1604 .	

SCAC R/L

Recommendations
Empfehlungen
Rekommendationer
Page: Seite: Sida:
B12-B14, B18

91°

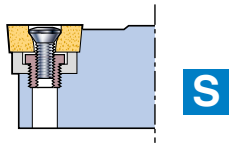

The drawing shows right-hand version. Left-hand version reversed.
Die Zeichnung zeigt Rechtsausführung. Linksausführung umgekehrt.
Ritningen visar högerutförande. Vänsterutförande spegelvänt.

	h=h ₁	b	l ₁	l ₂	f						CCMW CCMT CCXT	Page: Seite: Sida: B179-B184
SCACR/L 0808K06 SCACR/L 1010M06	8 10	8 10	125 150	- -	8,5 10,5	FTX072507	NY7X	-	-	-	0602 . .	
SCACR/L 1212M09 SCACR/L 1414M09	12 14	12 14	150 150	- -	12,5 14,5	FTX154010	NY15X	-	-	-	09T3 . .	

SCFC R/L

Recommendations
Empfehlungen
Rekommendationer





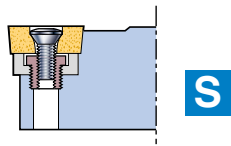

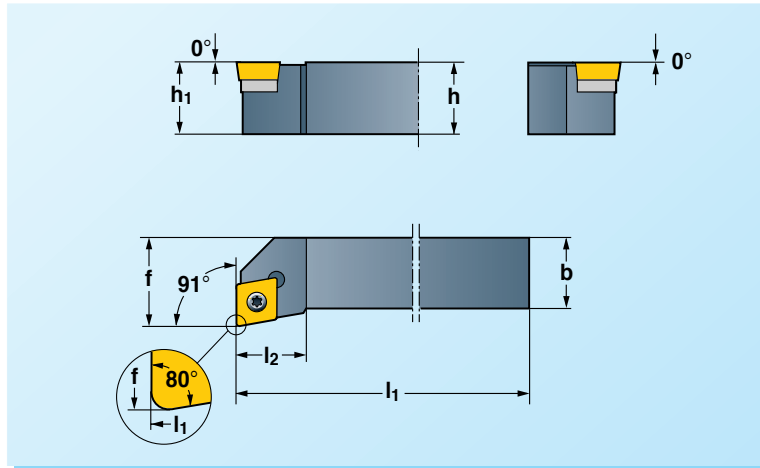

Page: Seite: Sida:

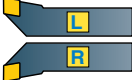
B12-B14, B18



The drawing shows right-hand version. Left-hand version reversed.
Die Zeichnung zeigt Rechtsausführung. Linksausführung umgekehrt.
Ritningen visar högerutförande. Vänsterutförande spegelvänt.



 	h=h ₁	b	l ₁	l ₂	f		 torx				CCMW * CCMT CCXT 	Page: Seite: Sida: B179-B184
SCFCR/L 0808D06 SCFCR/L 1010E06	8 10	8 10	60 70	10 10	10 12	FTX072507	NY7X	–	–	–	0602 ..	
SCFCR/L 1212F09 SCFCR/L 1616H09	12 16	12 16	80 100	16 16	16 20	FTX154010 FTX153512	NY15X NY15X	– UCC09	– RSM5T	– NY2.5	09T3 ..	

SCGC R/L

Recommendations
Empfehlungen
Rekommendationer





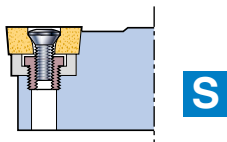

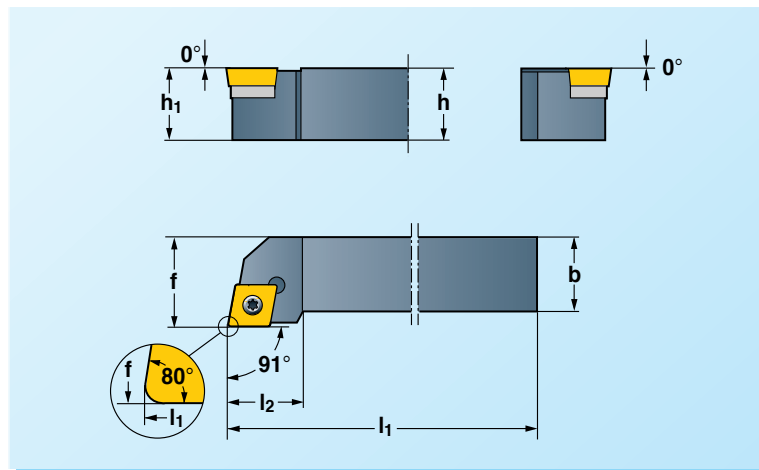

Page: Seite: Sida:



B12-B14, B18



The drawing shows right-hand version. Left-hand version reversed.
Die Zeichnung zeigt Rechtsausführung. Linksausführung umgekehrt.
Ritningen visar högerutförande. Vänsterutförande spegelvänt.



 	h=h ₁	b	l ₁	l ₂	f		 torx				CCMW * CCMT CCXT 	Page: Seite: Sida: B179-B184
SCGCR/L 0808D06 SCGCR/L 1010E06	8 10	8 10	60 70	10 10	10 12	FTX072507	NY7X	–	–	–	0602 ..	
SCGCR/L 1212F09 SCGCR/L 1616H09	12 16	12 16	80 100	16 16	16 20	FTX154010 FTX153512	NY15X NY15X	– UCC09	– RSM5T	– NY2.5	09T3 ..	

*
 Selection of cutting geometry page:
 Wahl der Schneidgeometrie, Seite:
 Val av skärgeometri, sid:

B27-B39

Ordering example:

Bestellbeispiel: **SCGCR 1616H09**

Beställningsexempel:

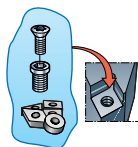

Spare parts shown in the coloured columns are supplied assembled in each tool.

Die in den farbigen Spalten aufgeführten Ersatzteile sind in den Werkzeugen montiert.

Reservdelar i de färgade kolumnerna ingår monterade i varje verktyg.

STGC R/L

Recommendations
Empfehlungen
Rekommendationer

Page: Seite: Sida:

B12-B14, B18

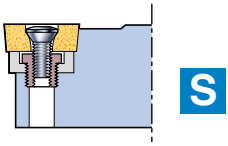
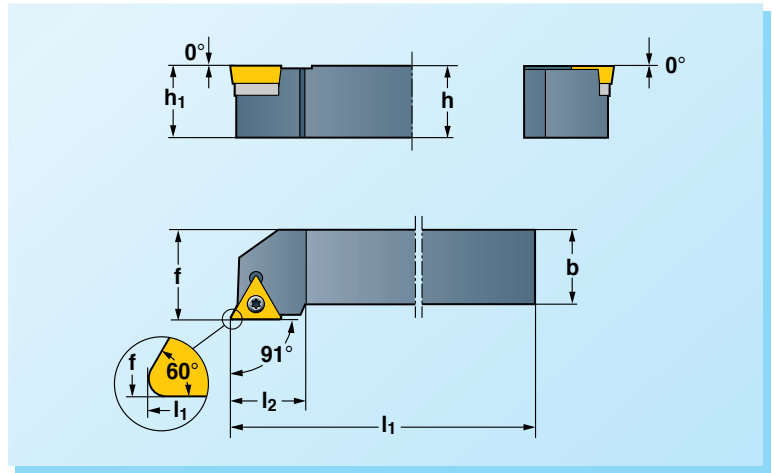

The drawing shows right-hand version. Left-hand version reversed.
Die Zeichnung zeigt Rechtsausführung. Linksausführung umgekehrt.
Ritningen visar högerutförande. Vänsterutförande spegelvänt.

B

	$h=h_1$	b	l_1	l_2	f		 torx				TCMW * TCMT TCGT	Page: Seite: Sida: B179-B184
STGCR/L 0808D09 STGCR/L 1010E09	8 10	8 10	60 70	12 12	10 12	FTX072206	NY7X	-	-	-	0902 ..	
STGCR/L 1212F11 STGCR/L 1616H11	12 16	12 16	80 100	15 15	16 20	FTX072507	NY7X	-	-	-	1102 ..	
STGCR/L 1616H16 STGCR/L 2020K16 STGCR/L 2525M16 STGCR/L 3225P16	16 20 25 32	16 20 25 25	100 125 150 170	21 21 21 21	20 25 32 32	FTX153512	NY15X	UTC16	RSM5T	NY2.5	16T3 ..	

STFC R/L

Recommendations
Empfehlungen
Rekommendationer

Page: Seite: Sida:

B12-B14, B18

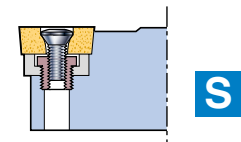
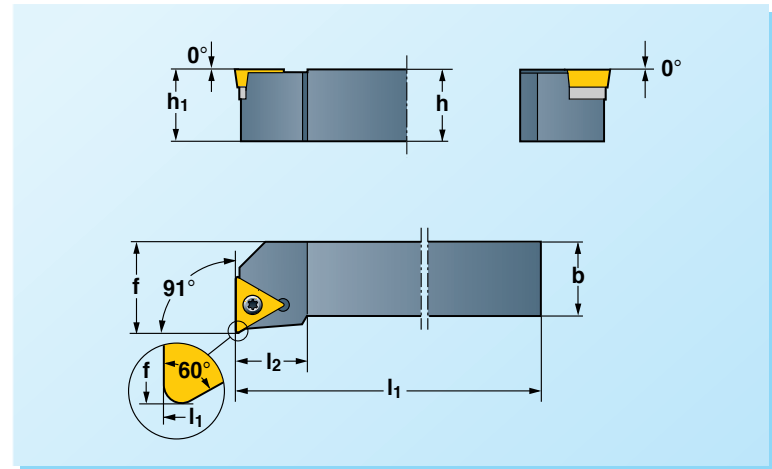

The drawing shows right-hand version. Left-hand version reversed.
Die Zeichnung zeigt Rechtsausführung. Linksausführung umgekehrt.
Ritningen visar högerutförande. Vänsterutförande spegelvänt.

	$h=h_1$	b	l_1	l_2	f		 torx				TCMW * TCMT TCGT	Page: Seite: Sida: B179-B184
STFCR/L 1616H16 STFCR/L 2020K16 STFCR/L 2525M16 STFCR/L 3225P16	16 20 25 32	16 20 25 25	100 125 150 170	20 20 20 20	20 25 32 32	FTX153512	NY15X	UTC16	RSM5T	NY2.5	16T3 ..	

STFC R/L M

Recommendations
Empfehlungen
Rekommendationer

Page: Seite: Sida:

B12-B14, B18

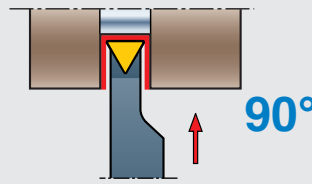



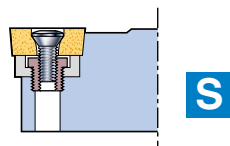



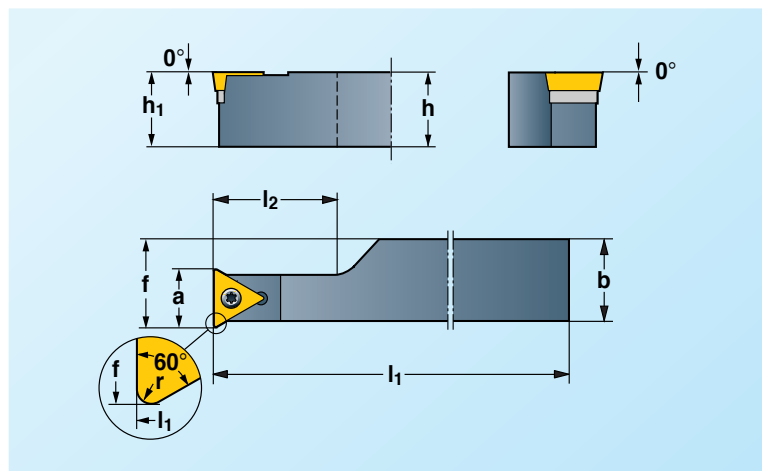





90°

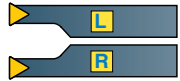

The drawing shows right-hand version. Left-hand version reversed.
Die Zeichnung zeigt Rechtsausführung. Linksausführung umgekehrt.
Ritningen visar högerutförande. Vänsterutförande spegelvänt.



	h=h ₁	b	l ₁	l ₂	f	a	r						TCMW * TCMT TCGT 	Page: Seite: Sida: B179-B184
									torx				TCMW * TCMT TCGT 	Page: Seite: Sida: B179-B184
STFCR/L 2020K11 M	20	20	125	25	20,4	10,4	0,4	FTX072507	NY7X	–	–	–	1102 . .	
STFCR/L 2525M11 M	25	25	150	25	25,4	10,4	0,4							
STFCR/L 2525M16 M	25	25	150	35	25,6	15,3	0,8	FTX153514	NY15X	UTC16	RSM508	NY 3.5	16T3 . .	
STFCR/L 3225P16 M	32	25	170	35	25,6	15,3	0,8							

SDAC R/L

Recommendations
Empfehlungen
Rekommendationer

Page: Seite: Sida:

B12-B14, B18

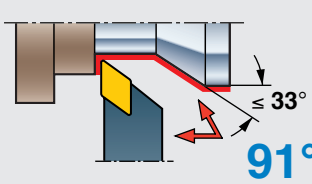



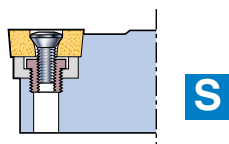



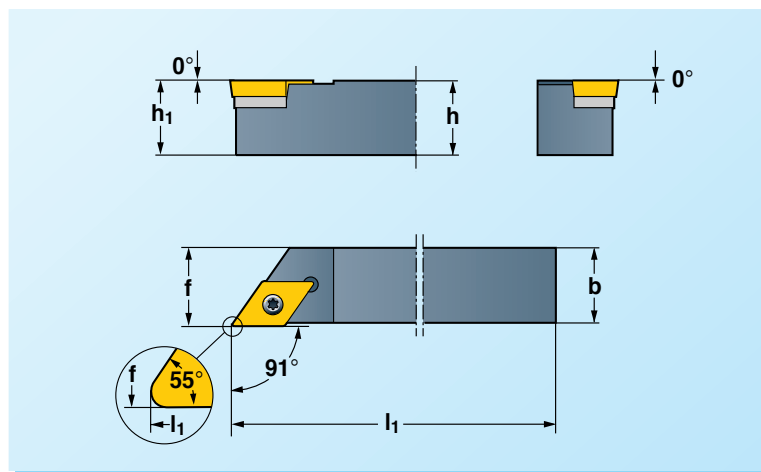





≤ 33°
91°



The drawing shows right-hand version. Left-hand version reversed.
Die Zeichnung zeigt Rechtsausführung. Linksausführung umgekehrt.
Ritningen visar högerutförande. Vänsterutförande spegelvänt.



	h=h ₁	b	l ₁	l ₂	f						DCMW * DCMT DCXT 	Page: Seite: Sida: B179-B184
							torx				DCMW * DCMT DCXT 	Page: Seite: Sida: B179-B184
SDACR/L 0808K07	8	8	125	–	8,5							
SDACR/L 1010M07	10	10	150	–	10,5	FTX072507	NY7X	–	–	–	0702 . .	
SDACR/L 1212M07	12	12	150	–	12,5							
SDACR/L 1414M11	14	14	150	–	14,5	FTX154010	NY15X	–	–	–	11T3 . .	

*
 Selection of cutting geometry page:
Wahl der Schneidengeometrie, Seite:
 Val av skärgeometri, sid:

B27-B39

Ordering example:

Bestellbeispiel: **SDACR 1414M11**

Beställningsexempel:

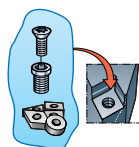

Spare parts shown in the coloured columns are supplied assembled in each tool.

Die in den farbigen Spalten aufgeführten Ersatzteile sind in den Werkzeugen montiert.

Reservdelar i de färgade kolumnerna ingår monterade i varje verktyg.

SCBC R/L



Recommendations
Empfehlungen
Rekommendationer

Page: Seite: Sida:

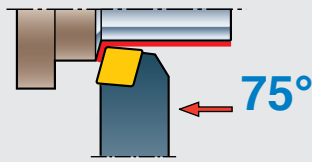
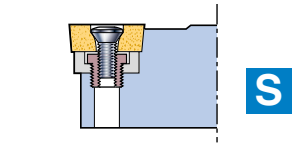
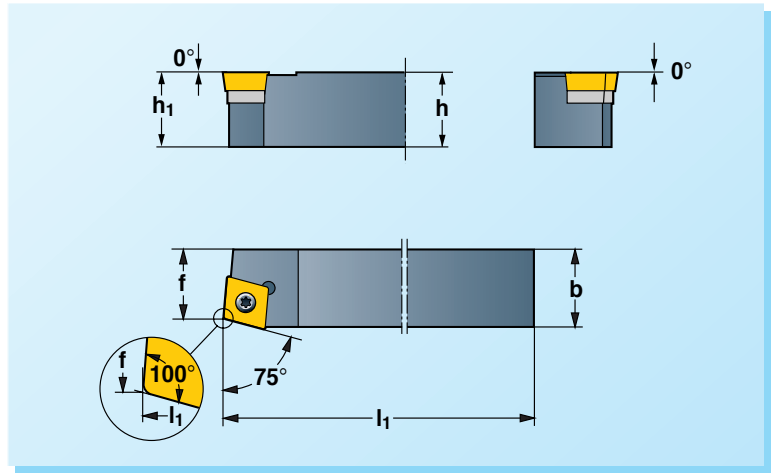
B12-B14, B18

B The drawing shows right-hand version. Left-hand version reversed.
Die Zeichnung zeigt Rechtsausführung. Linksausführung umgekehrt.
Ritningen visar högerutförande. Vänsterutförande spegelvänt.

	h=h ₁	b	l ₁	l ₂	f		 torx				CCMW * CCMT CCXT	 Page: Seite: Sida: B179-B184
SCBCR/L 0808D06	8	8	60	–	7	FTX072507	NY7X	–	–	–	0602 ..	
SCBCR/L 1010E06	10	10	70	–	9							
SCBCR/L 1616H09	16	16	100	–	13	FTX153512	NY15X	UCC09	RSM5T	NY2.5	09T3 ..	

SCRC R/L





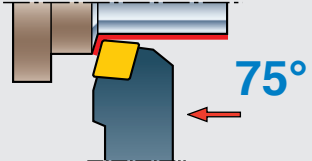
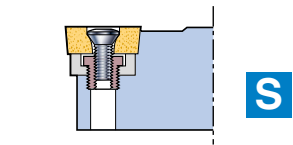
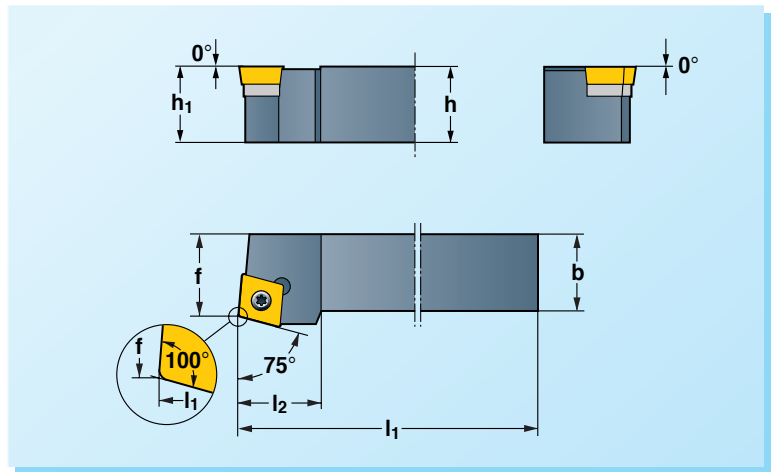

Recommendations
Empfehlungen
Rekommendationer

Page: Seite: Sida:

B12-B14, B18

The drawing shows right-hand version. Left-hand version reversed.
Die Zeichnung zeigt Rechtsausführung. Linksausführung umgekehrt.
Ritningen visar högerutförande. Vänsterutförande spegelvänt.

	h=h ₁	b	l ₁	l ₂	f		 torx				CCMW * CCMT CCXT	 Page: Seite: Sida: B179-B184
SCRCR/L 1212F09	12	12	80	16	13	FTX154010	NY15X	–	–	–	09T3 ..	
SCRCR/L 1616H09	16	16	100	16	17	FTX153512	NY15X	UCC09	RSM5T	NY2.5		

SSBC R/L

Recommendations
Empfehlungen
Rekommendationer

Page: Seite: Sida:
B12-B14, B18

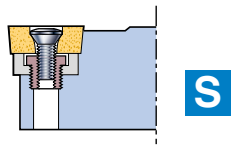

The drawing shows right-hand version. Left-hand version reversed.
Die Zeichnung zeigt Rechtsausführung. Linksausführung umgekehrt.
Ritningen visar högerutförande. Vänsterutförande spegelvänt.

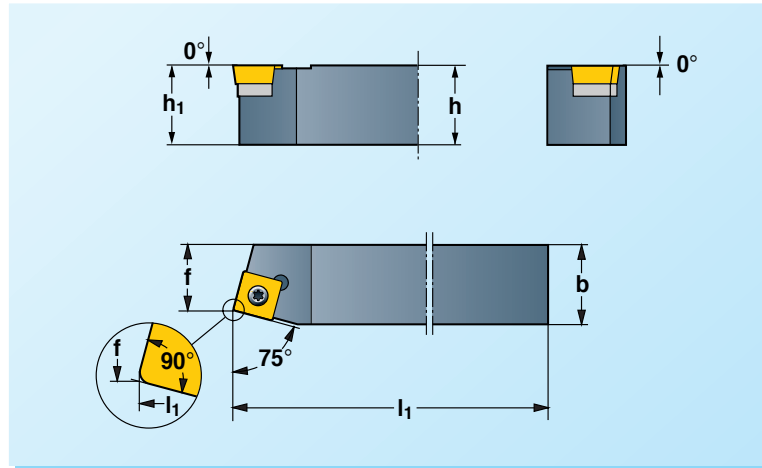

	$h=h_1$	b	l_1	l_2	f						SCMW * SCMT SCGT	Page: Seite: Sida: B179-B184
SSBCR/L 2020K12	20	20	125	–	17	FTX154512	torx NY15X	USC12	RSM6	NY3	1204 . .	
SSBCR/L 2525M12	25	25	150	–	22							
SSBCR/L 3225P12	32	25	170	–	22							

SSKC R/L

Recommendations
Empfehlungen
Rekommendationer

Page: Seite: Sida:
B12-B14, B18

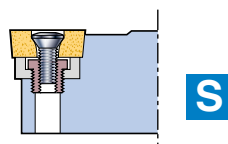

The drawing shows right-hand version. Left-hand version reversed.
Die Zeichnung zeigt Rechtsausführung. Linksausführung umgekehrt.
Ritningen visar högerutförande. Vänsterutförande spegelvänt.

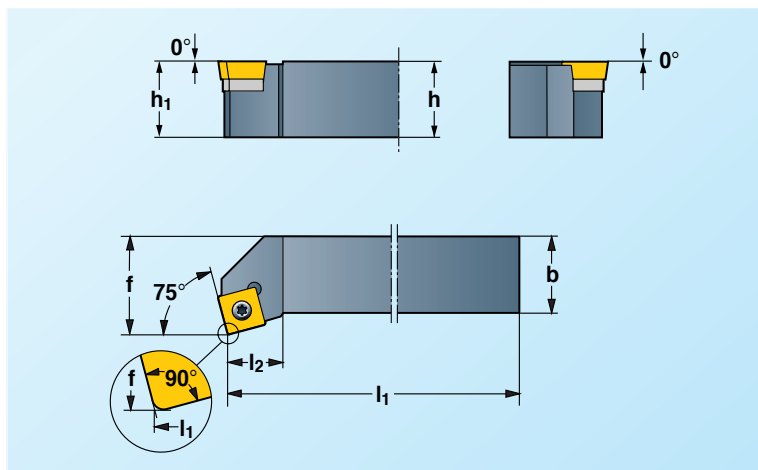

	$h=h_1$	b	l_1	l_2	f						SCMW * SCMT SCGT	Page: Seite: Sida: B179-B184
SSKCR/L 1616H09	16	16	100	13	20	FTX153512	torx NY15X	USC09	RSM5T	NY2.5	09T3 . .	
SSKCR/L 2020K12	20	20	125	16	25	FTX154512	torx NY15X	USC12	RSM6	NY3	1204 . .	
SSKCR/L 2525M12	25	25	150	18	32							
SSKCR/L 3225P12	32	25	170	18	32							

*
 Selection of cutting geometry page:
Wahl der Schneidgeometrie, Seite:
 Val av skärgeometri, sid:

B27-B39

Ordering example:
Bestellbeispiel: **SSKCR 1616H09**
Beställningsexempel:

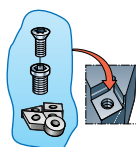

Spare parts shown in the coloured columns are supplied assembled in each tool.

Die in den farbigen Spalten aufgeführten Ersatzteile sind in den Werkzeugen montiert.

Reservdelar i de färgade kolumnerna ingår monterade i varje verktyg.

SVVB N
SVVC N

Recommendations
Empfehlungen
Rekomendationer
Page: Seite: Sida:
B12-B14, B18

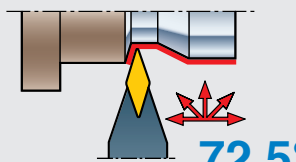



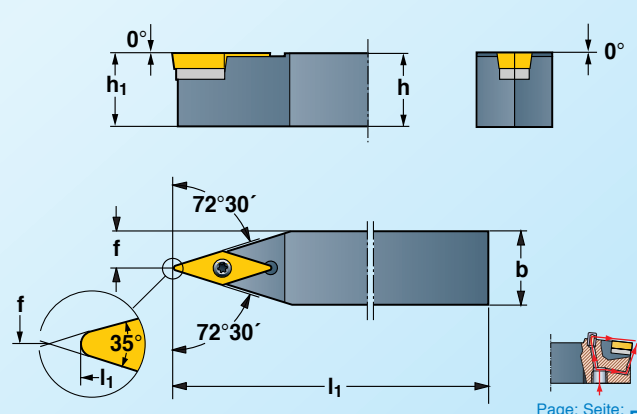

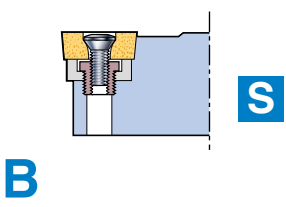

72,5°



Page: Seite: B24 - B26
Sida: B24 - B26



B

	h=h ₁	b	l ₁	l ₂	f		 torx				VBMW VCMW VBMT VCMT VCXT 	Page: Seite: Sida: B179-B184
SVVCN 1212M11	12	12	150	-	6	FTX072507	NY7X	-	-	-	VCM_1103 ..	
SVVCN 1616M11	16	16	150	-	8							
SVVCN 2020K11	20	20	125	-	10							
SVVCN 2525M11	25	25	150	-	12,5							
SVVBN 2020K16	20	20	125	-	10	FTX153512	NY15X	UVB16	RSM5T	NY2.5	VBM_/VCM_1604 ..	
SVVBN 2525M16	25	25	150	-	12,5							
SVVBN 3225P16	32	25	170	-	12,5							

SDNC N

Recommendations
Empfehlungen
Rekomendationer
Page: Seite: Sida:
B12-B14, B18

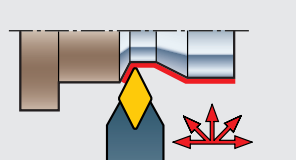



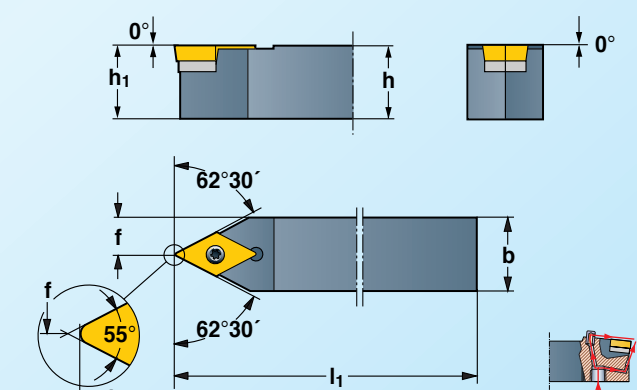

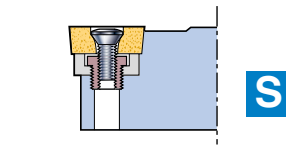

62,5°

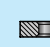

Page: Seite: B24 - B26
Sida: B24 - B26



	h=h ₁	b	l ₁	l ₂	f		 torx				DCMW * DCMT DCXT 	Page: Seite: Sida: B179-B184
SDNCN 0808K07	8	8	125	-	4	FTX072507	NY7X	-	-	-	0702 ..	
SDNCN 1010M07	10	10	150	-	5							
SDNCN 1212M07	12	12	150	-	6							
SDNCN 1414M11	14	14	150	-	7	FTX154010	NY15X	-	-	-	11T3 ..	
SDNCN 1616M11	16	16	150	-	8	FTX153514	NY15X	UDC11	RSM508	NY3.5		
SDNCN 2020K11	20	20	125	-	10	FTX153514	NY15X	UDC11	RSM508	NY3.5		
SDNCN 2525M11	25	25	150	-	12,5	FTX153514	NY15X	UDC11	RSM508	NY3.5		
SDNCN 2525M15	25	25	150	-	12,5	FTX154515	NY15X	UDC15	RSM610	NY4.5	1504 ..	
SDNCN 3225P15	32	25	170	-	12,5							